

LEGEND

- (FH) FIRE HYDRANT / (DFH) DUCKFOOT
- × (VS) STOP VALVE
- ✕ (VA) SCOUR ASSEMBLY
- (TB) TAPPING BAND
- × (WM) WATER METER (SEQ 20φ)
- └ (EC) END CAP
- ├ (T) TEE
- ^ (RE) REDUCER
- (B) BEND
- (D) DI CL WATER MAIN CROSSING
- - - - - (C) CONDUIT / CROSSING
- (E) EXISTING WATER

NOTES
 - ALL WATER RETICULATION PIPES ARE Ø180 PE-100 PN16 U.N.O.
 - ALL WATER SERVICE CROSSING PIPES ARE Ø100 PVC-U PN16 U.N.O.
 - ALL FIRE HYDRANTS ARE Ø100 SPRING U.N.O.

REGISTERED CADASTRAL SURVEYOR (QLD) CERTIFICATION

LandPartners Pty Ltd, hereby certify that the horizontal and vertical locations, and dimensions shown on this plan are a true and correct record of the As Constructed information.

Signed: *R. G. Andrew* Date: 26/08/2024
 (Authorised Delegate)

LandPartners Pty Ltd, Registered Cadastral Surveyor SBQ ID 4118

ENGINEER'S CERTIFICATION

I, _____, hereby certify that:

1. The information contained in this drawing / document is in compliance with approved drawings and design.
2. The new water and sewerage works defined by this drawing have been designed and constructed in accordance with the SEQ Code.
3. This represents an accurate record of as-constructed works.
4. I accept responsibility for the information contained in this drawing / document.

RPEQ (signature) _____ RPEQ No. _____ Date: _____

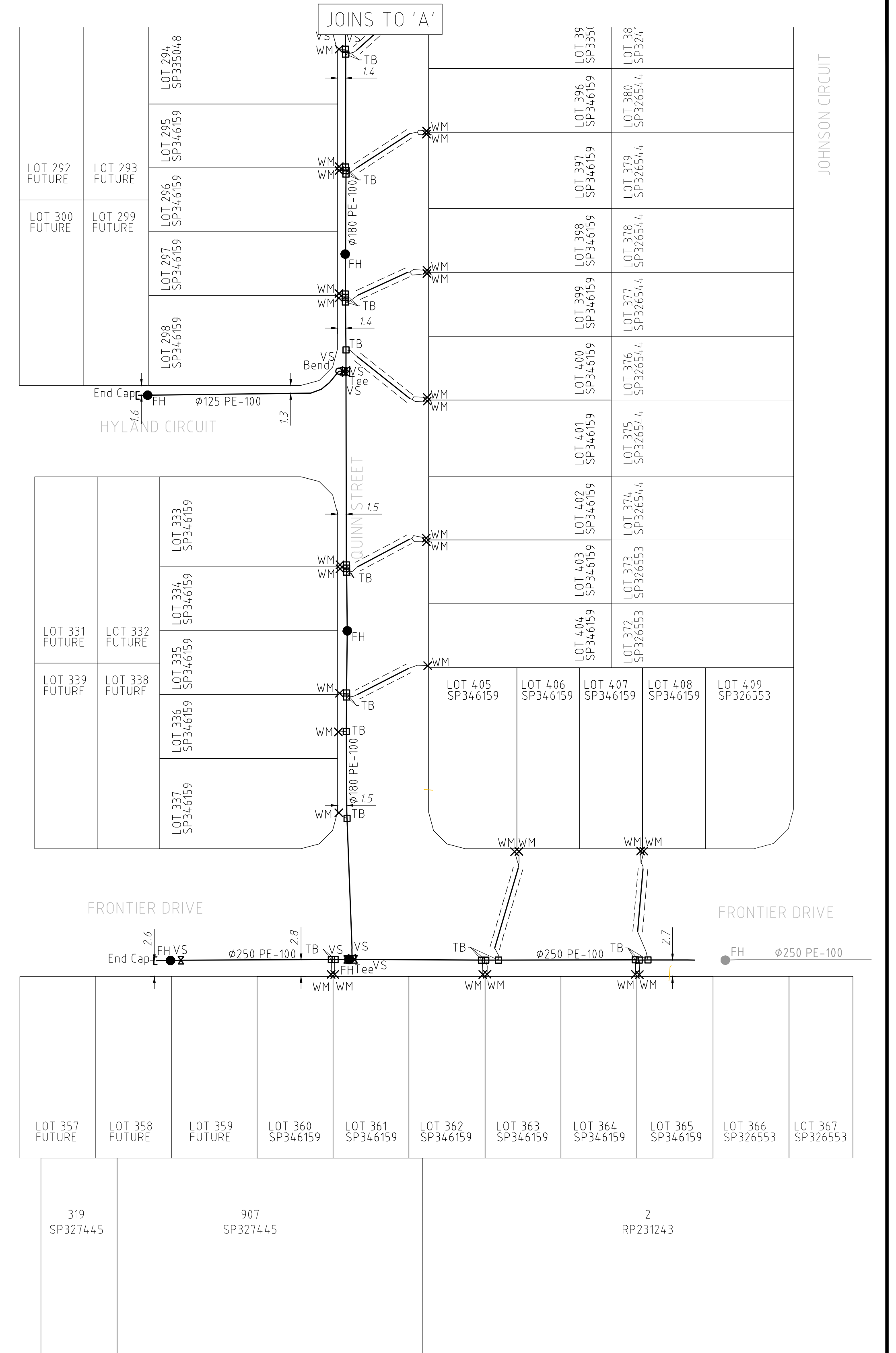
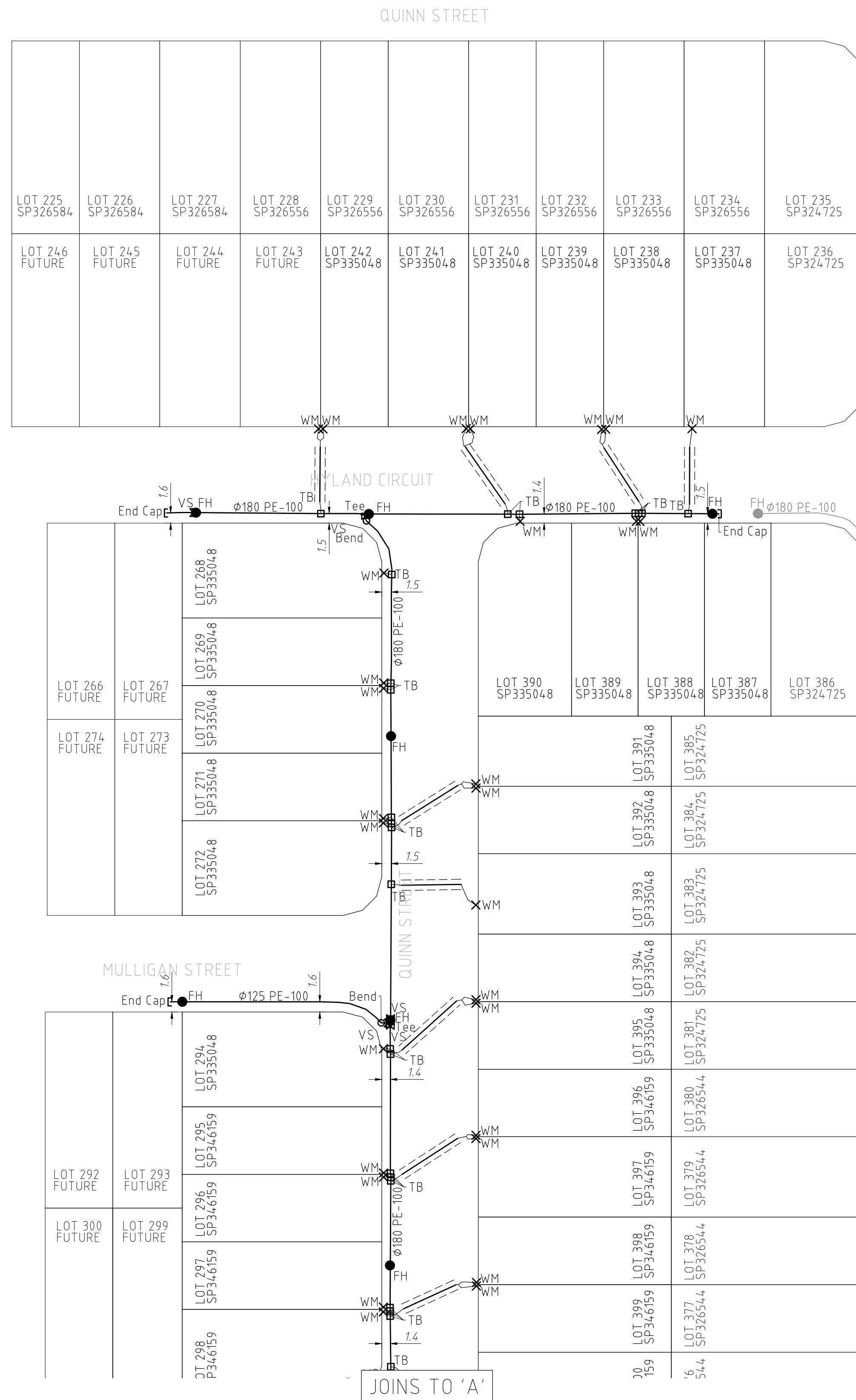

AS CONSTRUCTED

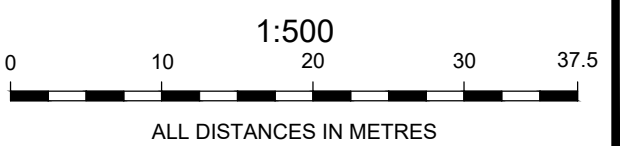

A1

INDEX	DATE	INITIALS	REVISIONS	DRAWN	CHECKED	PASSED
1	26/08/2024		INITIAL ISSUE	MK	RA	RA

DRAWN	CHECKED	PASSED	DATE
MJK	RA	RA	16/08/2024
			26/08/2024
			26/08/2024



Sydney Office
 Level 1
 15 Little Creek Street
 Milton QLD 4064
 PO Box 1399
 Milton
 QLD 4064
 P (07) 3842 1000
 F (07) 3842 1001
 E info@landpartners.com.au
 www.landpartners.com.au



Queensland Urban Utilities

236-240 MONTEREA ROAD PRECINCT 2 - STAGES 8 & 12
 AS CONSTRUCTED WATER
 22-PNT-60882

SCALE 1:500

SHEET 1 OF 1 SHEETS

DRAWING NO.

BRSS6904-008-40-1