



LOT 337
S3173

LOT 917
SP326602

NOTES
-ALL STORMWATER PIPES ARE RCP '3' U.N.O.

LOT 918
SP335047

REGISTERED SURVEYOR'S CERTIFICATION

I, LandPartners Pty Ltd, hereby certify that the vertical and horizontal locations and dimensions shown on this plan are a true and correct record and were located by survey.

R. G. Anderson, Authorised Delegate
Registered Surveyor (Sig) Reg. Surveyor No. S4118 Date

AS CONSTRUCTED CERTIFICATION

(Company's representative Name) (Signature)
(Date) (RPEQ)
Being a duly representative of:- (Company Name)

Hereby certify that
1. The information contained in this drawing / document is in compliance with approved drawings and design supplied under the terms of the contract.
2. This represents an accurate "As constructed" record of works carried out and accept responsibility for the information contained in this drawing / document.

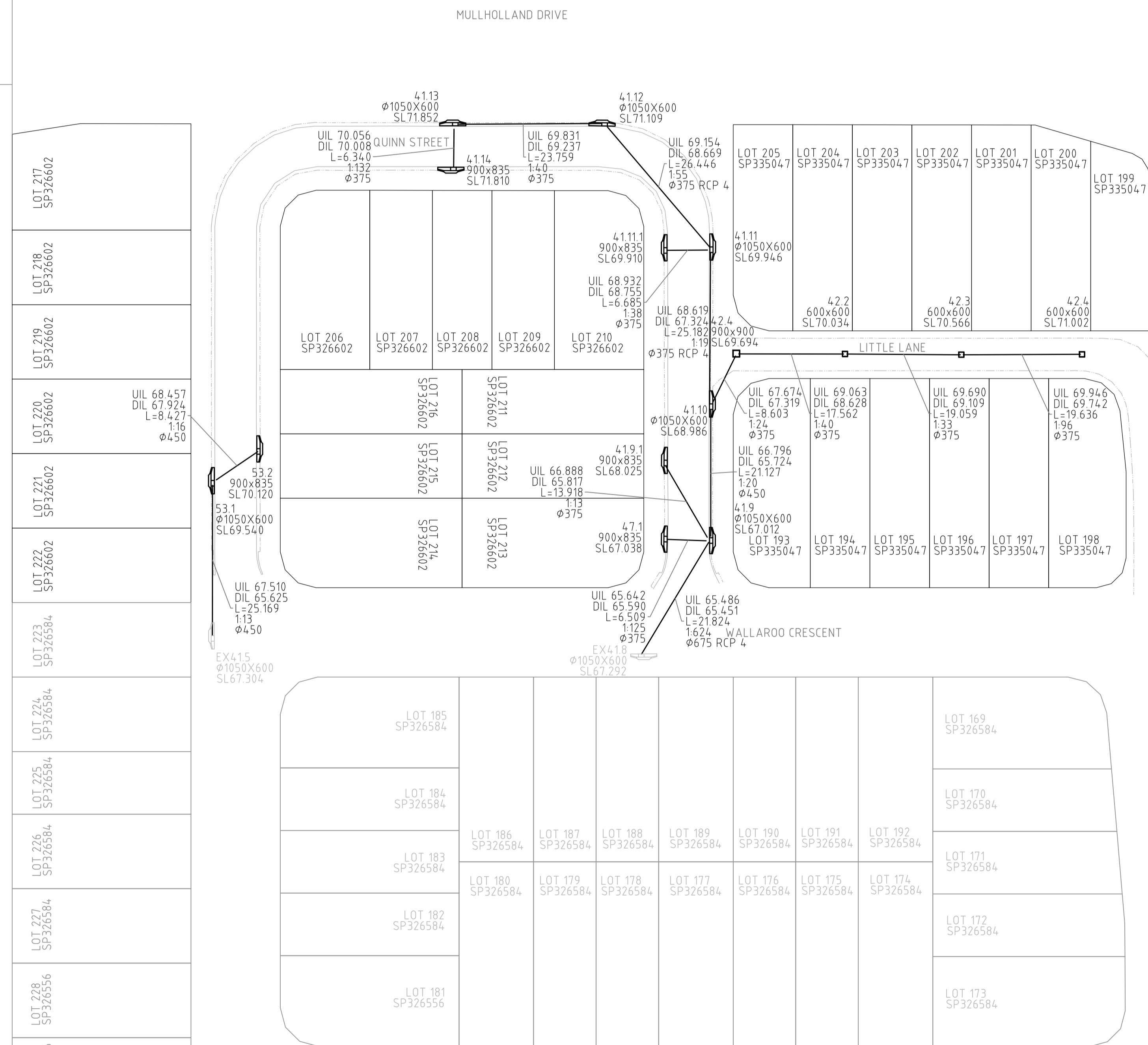

AS CONSTRUCTED

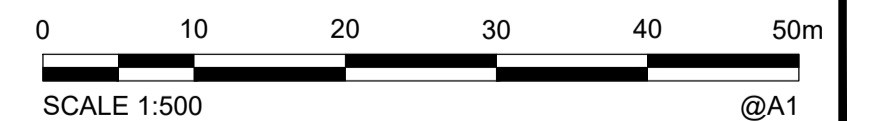

COORDINATE DATUM NOTE:
HORIZONTAL COORDINATES (E,N) SUPPLIED ARE MAPPING GRID OF AUSTRALIA (MGA), ZONE 56 BASED ON THE UNIVERSAL TRANSVERSE MERCATOR PROJECTION AND THE GEOCENTRIC DATUM OF AUSTRALIA 2020.

A1	1	15/02/2024	INITIAL ISSUE	MJK	B/B	RA
	INDEX	DATE	REVISIONS	DRAWN	CHECKED	PASSED

DRAWN	MJK	15/02/2024
CHECKED	B/B	13/02/2024
PASSED	RA	15/02/2024
INITIALS	DATE	



Brisbane Office
Level 1
18 Lime Cobb Street
Milton QLD 4064
PO Box 1399
Milton
QLD 4064
p: (07) 3842 1000
f: (07) 3842 1001
e: info@landpartners.com.au
www.landpartners.com.au



IPSWICH CITY COUNCIL

236-240 MONTEREA RD PRECINCT 2 - STAGES 7 & 7A
AS CONSTRUCTED STORMWATER
6536/2018/MAPDA/C

SCALE 1:500
SHEET 1 OF 1 SHEETS
DRAWING NO.
BRSS6904-007-71-1