

FOR CONSTRUCTION

ATTN: CIVIL CONTRACTOR

THE COVER ABOVE THE STORM WATER MAIN AND THE SEWER MAIN HAS BEEN REVIEWED AT THE ELECTRICAL CROSSING POINTS. THE ELECTRICAL ROAD CROSSING CONDUITS ARE TO BE INSTALLED WITH 100mm (300mm PREFERRED) SEPARATION TO THE STORM WATER MAIN. 500mm (min) SEPARATION TO THE SEWER MAIN, 600mm COVER (min) ON THE FOOTPATH & 750mm COVER (min) UNDER THE ROAD. CONFLICTS ARE TO BE RESOLVED AS FOLLOWS:

- STN'S 6 TO 7 - 75mm COVER ON 900x600mm STORM WATER MAIN. INSTALL ELECTRICAL CONDUIT UNDER THE STORM WATER MAIN.

WHERE THE ELECTRICAL / NBN CONDUITS ARE INSTALLED UNDER THE STORM WATER MAINS, THEY SHALL BE GRADUALLY BROUGHT BACK UP TO A MAXIMUM DEPTH OF 1.4m AT THE ENDS.

"AS CONSTRUCTED" DOCUMENTS

The electrical contractor shall email the "as constructed" drawing, test results & closure documents to:

- contestable@energen.com.au
- as.constructed@robus.com.au

UNDERGROUND CABLE CERTIFICATION

All cables detailed on this drawing have been checked using the cable locator described below and are, according to measurements taken, on the correct alignment and at correct depths below the finished level, except as marked up. Alignments are subject to the accuracy of survey pegs present at the time of measurement.

Make: _____ Model: _____
 Serial No: _____ Date Cables Checked: ____/____/____
 Name of Person Who Conducted Checks: _____
 Certified (signature of checker): _____
 Phone No. of checker: _____

APA GAS INSTALLATION

GAS IS TO BE RETICULATED THROUGHOUT THIS PROJECT BY APA. THE ELECTRICAL CONTRACTOR SHALL PROVIDE ALL VERGE TRENCHES FOR APA.

REFER TO APA'S DESIGN FOR ALL LOCATIONS OF JOINT USE & SEPARATE TRENCHES.

BE AWARE THAT ENERGEN WILL ONLY PERMIT A JOINT USE TRENCH WHERE THERE IS NOT MORE THAN ONE 125mm ELECTRICITY CONDUIT.

THE SEPARATE GAS ALIGNMENT IS AS SPECIFIED ON THE APA DESIGN BUT THE GAS MAINS MUST CLEAR THE STREET LIGHT FOUNDATION ALIGNMENT.

CAUTION GAS

ELECTRICAL CONTRACTOR TO USE HYDRO VAC AND ENGAGE AN AUTHORISED GAS SPOTTER FOR ANY EXCAVATION WITHIN 1m OF GAS MAIN.

CONSTRUCTION CONTACTS

ELECTRICAL ENGINEER
 ROBIN RUSSELL & ASSOCIATES PTY LTD
 DESIGNER
 WILLIAM SCHARDT - ph: 0419 778 552
CONSTRUCTION COORDINATOR
 BERNIE RUSSELL - ph: 0413 598 560

CIVIL ENGINEER
 BORNHORST & WARD Pty Ltd
 NICK ROZIS - ph: 0418 755 661

SURVEYOR
 LAND PARTNERS Pty Ltd
 SHANE SMITH - ph: 0438 803 065

LANDSCAPE ARCHITECT
 SAUNDERS HAVILL GROUP
 ROBERT McILROY - ph: 3251 9444

GAS
 APA
 SYLVIA HART - ph: 3215 6655

DATE	REV	REVISION	APP.	DATE	REV	REVISION	APP.	CURRENT REVISION CHANGES:
29/11/2021	A	PRELIMINARY ISSUE	R.R.					
10/12/2021	B	REVISED LOT CALCULATIONS	R.R.					
30/03/2022	C	FOR CONSTRUCTION	R.R.					
10/08/2022	D	SL ALIGNMENTS AMENDED	R.R.					

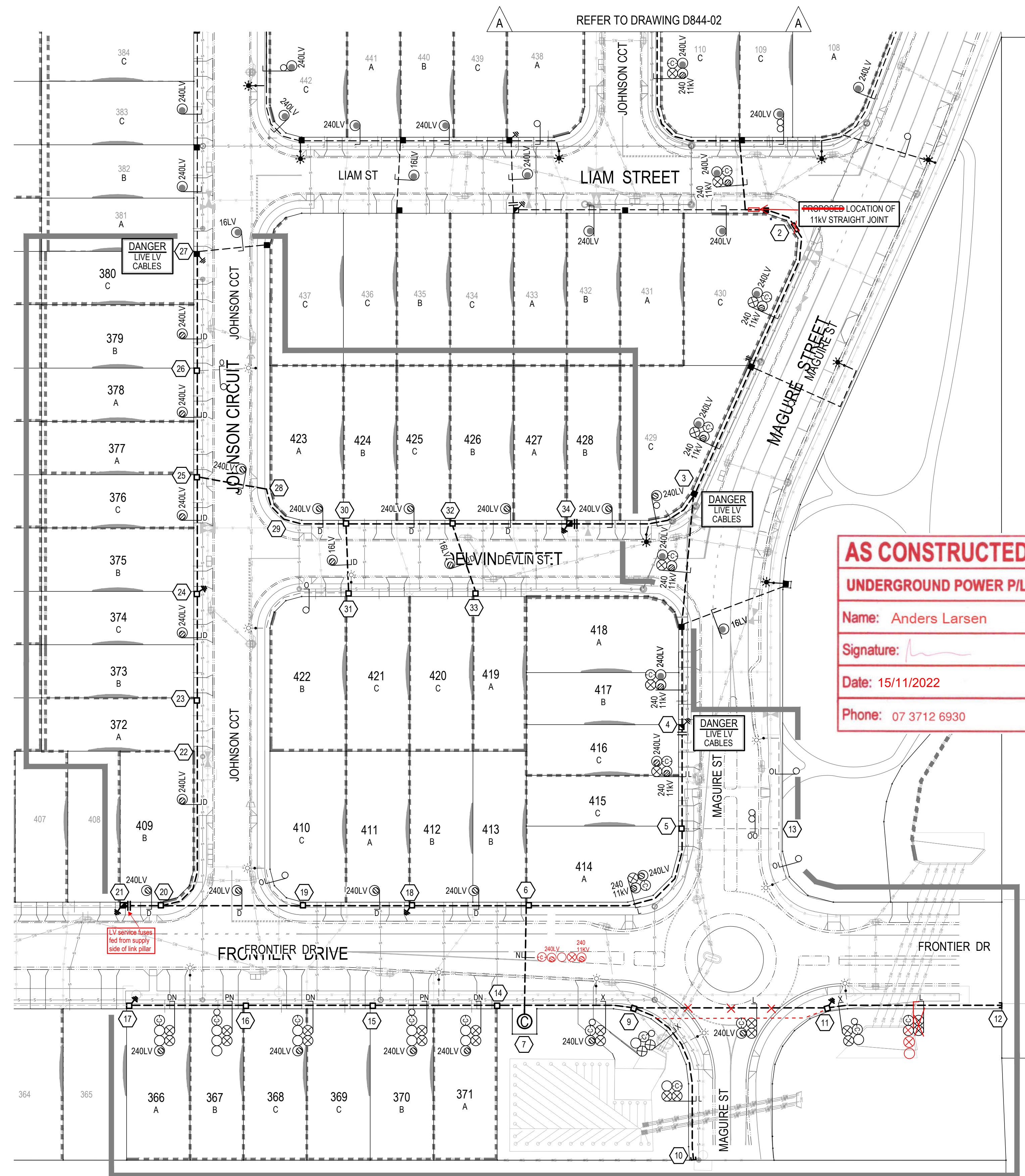
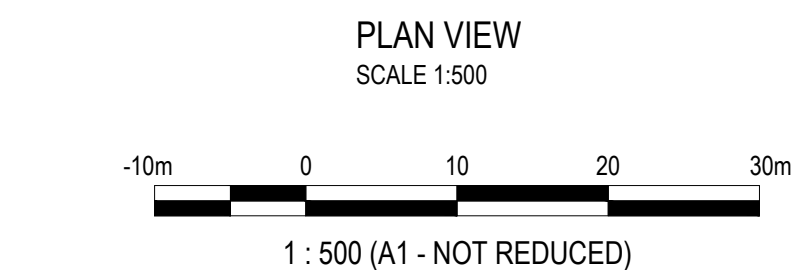

AS CONSTRUCTED
UNDERGROUND POWER P/L
 Name: Anders Larsen
 Signature: _____
 Date: 15/11/2022
 Phone: 07 3712 6930

GENERAL NOTES

IN THE EVENT OF CONFLICT BETWEEN THIS WORKS PLAN AND DRAWINGS AND SPECIFICATIONS OF THE RELEVANT FUTURE ASSET OWNER, I.E. ENERGEN, ERGON, LOCAL AUTHORITY, DEPARTMENT OF TRANSPORT & MAIN ROADS, NBN™, ETC., THE DRAWINGS AND SPECIFICATIONS OF THE FUTURE ASSET OWNER SHALL TAKE PRECEDENCE. EXCEPTIONS APPLY WHERE RRA DESIGN DOCUMENTATION SPECIFY CLEARANCES, DEPTHS & SEPARATIONS GREATER THAN THE MINIMUM REQUIRED BY THE AUTHORITIES.

THE CONTRACTOR SHALL NOT ACCEPT A VERBAL INSTRUCTION FROM ANY PERSON TO DEPART FROM THE REQUIREMENTS OF THIS WORKS PLAN OR RRA GENERAL SPECIFICATION. ANY DEPARTURE FROM THE WORKS PLAN OR SPECIFICATION MUST FIRST BE AUTHORISED IN WRITING BY THE CONTRACT SUPERINTENDENT.

ELECTRICAL CONTRACTOR

THE WORKS DETAILED ON THIS DRAWING SHALL BE CONSTRUCTED IN ACCORDANCE WITH ROBIN RUSSELL & ASSOCIATES' GENERAL SPECIFICATION FOR INSTALLATION OF ELECTRICITY RETICULATION AND STREET LIGHTING - ISSUE 'A'.

CIVIL CONTRACTOR

THE INSTALLATION OF ALL ELECTRICAL CONDUITS SHALL BE SUPERVISED BY THE HOLDER OF AN ELECTRICAL WORK LICENCE - ELECTRICAL SAFETY ACT 2002. ENERGEN CONDUITS AND TRANSFORMER SITE RETAINING WALLS SHALL BE INSTALLED STRICTLY IN ACCORDANCE WITH ENERGEN'S SPECIFICATIONS (SEE BELOW). THEY WILL BE INSPECTED FOR COMPLIANCE UPON COMPLETION.

WHERE ROAD-CROSSING CONDUITS ARE INSTALLED DEEPER THAN USUAL (UNDER CULVERTS OR PIPES) THEY MUST RISE TO A DEPTH OF NOT MORE THAN 1200mm AT EACH END. IF UNCERTAIN, SEEK ADVICE FROM RRA CONSTRUCTION COORDINATOR.

THE CIVIL CONTRACTOR SHALL INSTALL ENVELOPING CONDUITS UNDER RETAINING WALLS BEHIND PILLARS - TWO 100mm CONDUITS INTO EACH LOT (ONE FOR ELECTRICITY, ONE FOR COMMUNICATIONS), 500mm DEEP BEHIND THE PILLAR, NEAR GROUND LEVEL INSIDE THE LOT.

RELEVANT SPECIFICATIONS IN ENERGEN'S UNDERGROUND DISTRIBUTION CONSTRUCTION MANUAL ARE FOUND AT - SECTION C1: CONDUITS SECTION C2: EXCAVATION SECTION C3: TRANSFORMER SITES

THESE SECTIONS OF THE MANUAL CAN BE DOWNLOADED FROM THE FOLLOWING ENERGEN WEB SITE: https://swp.energen.com.au/service_providers/technical_docs/asp/technical_documents.asp

CIVIL ENGINEERS WHO HAVE REGISTERED FOR ACCESS TO THE FOLLOWING RRA WEBSITE MAY DOWNLOAD EXTRACTS FROM ENERGEN'S MANUAL AT: <http://www.robus.com.au>

THE CIVIL CONTRACTOR SHALL ENSURE THAT ALL CONDUITS HAVE BEEN INSTALLED BEFORE CONSTRUCTING RETAINING WALLS, PATHS, DRIVEWAYS & WATER SERVICES. THE CIVIL CONTRACTOR SHALL PLEASE INFORM THE ELECTRICAL CONTRACTOR OF ANY 'AS CONSTRUCTED' DEPARTURES FROM THE CIVIL DESIGN.

CARE: EXISTING STREET LIGHTS SHALL NOT BE RECOVERED UNLESS REPLACEMENT STREET LIGHTS WILL BE COMMISSIONED BEFORE NIGHTFALL. LIGHTING OF NEW OR ALTERED EXISTING ROADS MIGHT NOT COMPLY WITH SPECIFIED STANDARDS UNTIL NEW ROAD LIGHTING HAS BEEN COMMISSIONED. THE CIVIL CONTRACTOR SHALL APPLY APPROPRIATE RISK MANAGEMENT. E.G. WARNING SIGNS, SPEED RESTRICTIONS, TEMPORARY LIGHTING, ETC.

ON-SITE SERVICES CHECKS

ROBIN RUSSELL & ASSOCIATES GIVES NO WARRANTY REGARDING THE PRESENCE OR LOCATION OF BURIED SERVICES, INCLUDING NEWLY-INSTALLED SERVICES. "AS CONSTRUCTED" LOCATIONS MAY DIFFER FROM WHAT IS DRAWN ON THIS WORKS PLAN. CONTRACTORS SHALL BE RESPONSIBLE TO IDENTIFY AND LOCATE ALL BURIED SERVICES. INITIAL IDENTIFICATION CAN BE OBTAINED FROM: DIAL BEFORE YOU DIG SERVICE TELEPHONE 1100 FAX 1300 652 077 ON-LINE ENQUIRIES CAN BE MADE AT: <http://www.1100.com.au>

HAVING DETERMINED WHICH SERVICES MAY BE PRESENT, ON-SITE LOCATIONS SHOULD THEN BE ARRANGED WITH RELEVANT SERVICE AUTHORITIES. SEWERAGE AND WATER PLANS FOR THE SUBDIVISION MAY BE OBTAINED ON REQUEST FROM THE SUPERINTENDENT.

INSTALLATION OF RRA DESIGNED TELECOMMUNICATIONS CONDUITS

TELECOMS CONDUITS AND PITS SHALL BE SUPPLIED AND INSTALLED BY THE CIVIL AND ELECTRICAL CONTRACTORS AS SPECIFIED ON THE ASSOCIATED RRA WORKS PLAN. IN RESIDENTIAL SUBDIVISIONS, TELECOMMUNICATIONS CONDUITS SHALL BE INSTALLED GENERALLY IN SHARED TRENCHES, DIRECTLY ABOVE THE ELECTRICAL CONDUITS. IN COMMERCIAL SUBDIVISIONS OR OTHER SITUATIONS WHERE THIS IS NOT POSSIBLE, TELECOMMUNICATIONS CONDUITS SHALL BE INSTALLED IN A SEPARATE TRENCH ON THE SPECIFIED COMMUNICATIONS ALIGNMENT.

TELECOMMUNICATIONS INFRASTRUCTURE

CONDUITS & PITS to be designed by: Robin Russell & Associates
 TELECOMMUNICATIONS INFRASTRUCTURE to be provided by: NBNCo Limited

ROCK EXCAVATION BY ELECTRICAL CONTRACTOR

The electrical contractor shall:

- excavate electricity trenches to the depth required,
- excavate street light foundations to a depth of 1500mm.

SOURCE DOCUMENTS

CREATOR	DRAWING	DWG. NO.	REV. NO.	DATE
BORNHORST & WARD	CIVIL	CIV_18331_2MODEL(210511).dwg	-	05/11/2021
RRA	ELECTRICAL	D337	G	22/07/2021
RRA	ELECTRICAL	D631	B	29/09/2021
LANDPARTNERS	SURVEY	BRSS6944-000-104-88 LotCalcs_EXT.dwg	-	08/08/2022

LEGEND: ELECTRICAL

- EXISTING UNDERGROUND CABLE
- - - PROPOSED UNDERGROUND CABLE
- FUTURE UNDERGROUND CABLE
- BORED CONDUIT
- 12/13 STATION NUMBERS
- ⊙/⊙/⊙ PADMOUNT TRANSFORMER, EXISTING / PROPOSED / FUTURE
- ⊙/⊙/⊙ RING MAIN UNIT, EXISTING / PROPOSED / FUTURE
- ⊙/⊙/⊙ POLE TRANSFORMER, EXISTING / PROPOSED / FUTURE
- CABLE FAULT INDICATOR
- ⊙/⊙/⊙ SERVICE PILLAR, EXISTING / PROPOSED / FUTURE
- ⊙/⊙/⊙ LINK PILLAR, EXISTING / PROPOSED / FUTURE
- ⊙/⊙/⊙ LV LINKS (OPEN), EXISTING / PROPOSED / FUTURE
- ⊙/⊙/⊙ LV LINKS (CLOSED), EXISTING / PROPOSED / FUTURE
- EXISTING OVERHEAD ELECTRICITY MAINS
- PROPOSED OVERHEAD ELECTRICITY MAINS
- FUTURE OVERHEAD ELECTRICITY MAINS
- /○/○ HV POLE, EXISTING / PROPOSED / FUTURE
- /●/● HV + LV POLE, EXISTING / PROPOSED / FUTURE
- /●/● LV POLE, EXISTING / PROPOSED / FUTURE
- ⊙/⊙/⊙ EARTH, EXISTING / PROPOSED / FUTURE
- ⊙/⊙/⊙ STREET LIGHT, EXISTING / PROPOSED / FUTURE
- EXISTING NPL 3 STREETLIGHT CABLE
- - - PROPOSED NPL 3 STREETLIGHT CABLE
- FUTURE NPL 3 STREETLIGHT CABLE
- ⊙/⊙/⊙ NPL 3 STREET LIGHT, EXISTING / PROPOSED / FUTURE
- ⊙/⊙/⊙ NPL 3 SWITCHBOARD, EXISTING / PROPOSED / FUTURE
- EXISTING CONSUMERS UNDERGROUND CABLE
- - - PROPOSED CONSUMERS UNDERGROUND CABLE
- TO BE RECOVERED
- /●/● CABLE, EXISTING / PROPOSED
- /○/○ 32/40mm HD CONDUIT
- /○/○ 80/100mm LD CONDUIT
- /○/○ 100mm WHITE ENERGEN COMMS. CONDUIT
- /○/○ 125mm LD CONDUIT
- △ ELECTRIC CABLE MARKER PLATE

PILLARS ON ZERO LOT BOUNDARY

REQUIREMENTS FOR ELECTRICAL, GAS & COMMUNICATIONS CONTRACTORS

The proposed pillar shall be offset, as indicated, at the zero lot line boundary. The side of the pillar shall be aligned with the lot boundary, to provide at least 1.0m clearance from the future driveway.

A proposed streetlight shall be offset 1.0m from the zero lot line boundary, away from the future driveway.

COMMUNICATIONS PITS shall not clash with potential driveway positions indicated

GAS DOMESTIC SERVICE TEE-OFFS shall be adjusted to remain outside 600mm pillar exclusion zone if a pillar is offset to align with one side of a survey peg

NOT TO SCALE

RATE 3 LIGHTING REQUIRED:
 REFER TO RRA CONSTRUCTION PLAN S0107463 (RRA Ref: D844) FOR FULL DETAILS ON RATE 3 LIGHTING DESIGN FOR THIS STAGE.

SITE INFORMATION

TOTAL NUMBER OF LOTS: 35
 PROPERTY DESCRIPTION: PROPOSED LOTS 366 - 380, 409 - 428
 CANCELLING LOTS 908 ON SP309058

Robin Russell & Associates Pty. Ltd.
 CONSULTING ENGINEERS - ELECTRICAL

SUBDIVISION ELECTRICAL SERVICES
 204/5 Sabana Street, Stafford, QLD 4053
 Tel: (07) 3872 5556
 Fax: (07) 3872 5566
 Email: info@robus.com.au
 www.robus.com.au
 A.B.N. 78 010 589 661

COUNCIL	IPSWICH CITY	DESIGNED	W.Schardt	DESCRIPTION	ELECTRICITY RETICULATION - RESIDENTIAL
COUNCIL REF	6536/2018/MAPDA	DRAWN	B.Hyland	CLIENT	Monterea Land Holdings Pty Ltd
UBD REF	Map Grd 233	CHECKED	B.Ryan		
DWT REV.	V53-3 20210504	APPROVED	ROBIN RUSSELL RPEQ 1546		
DATE	29/11/2021	SIGNED	<i>Rob Russell</i>		

MONTEREA ESTATE STAGES 10 & 11
236-240 MONTERA ROAD
RIPLEY

LOCATION: MONTEREA ESTATE STAGES 10 & 11
 236-240 MONTERA ROAD
 RIPLEY

THIS DOCUMENT IS COPYRIGHT AND THE PROPERTY OF ROBIN RUSSELL & ASSOCIATES PTY LTD AND MUST NOT BE RETAINED, COPIED OR USED WITHOUT AUTHORITY.

DRAWING No. **D844-01 D**
 ENERGEN PROJECT No. **S0107462**
 SHEET No. **1 OF 4**

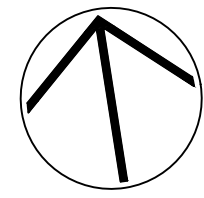

HV Straight Joint Installed

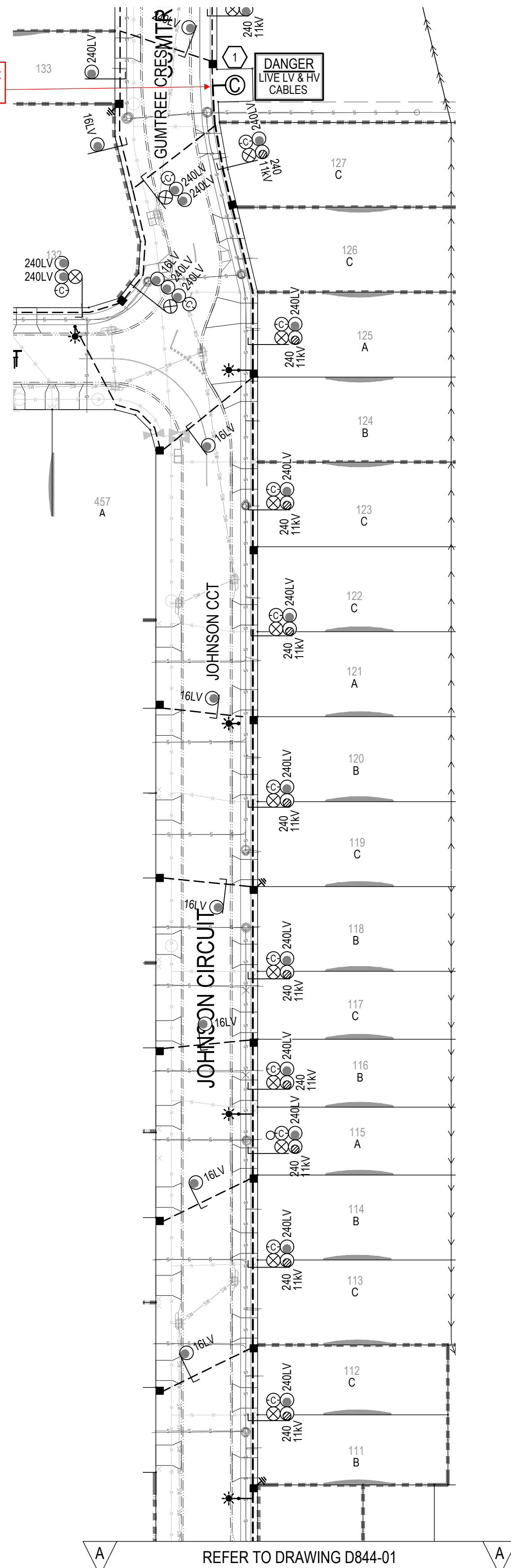

REFER TO DRAWING D844-01

FOR CONSTRUCTION

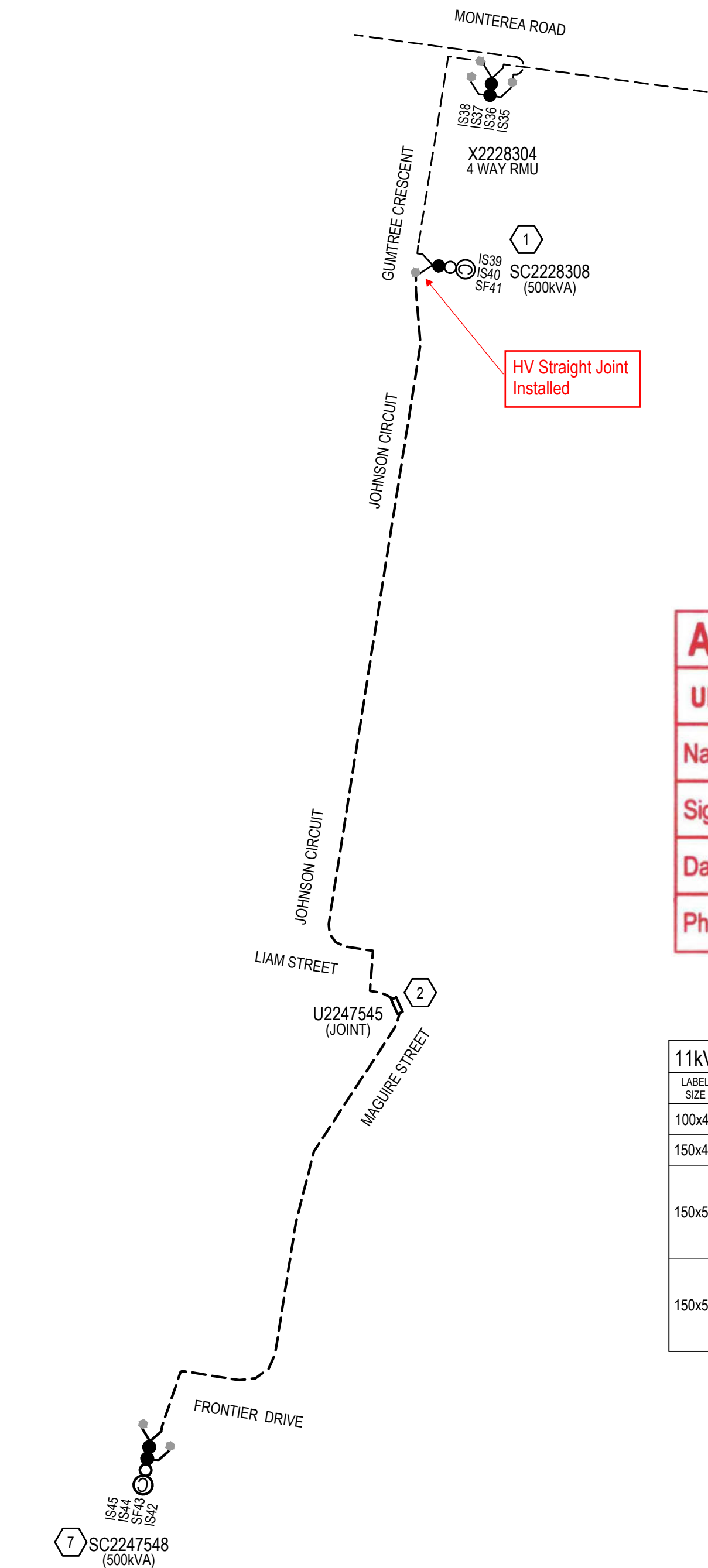
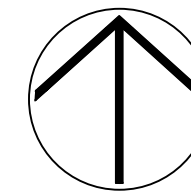

EXISTING AND PROPOSED 11kV SCHEMATIC

SCALE 1:1500
ALL NEW HV CABLES TO BE 3 x 1c 240mm AI TRIPLEX UNO

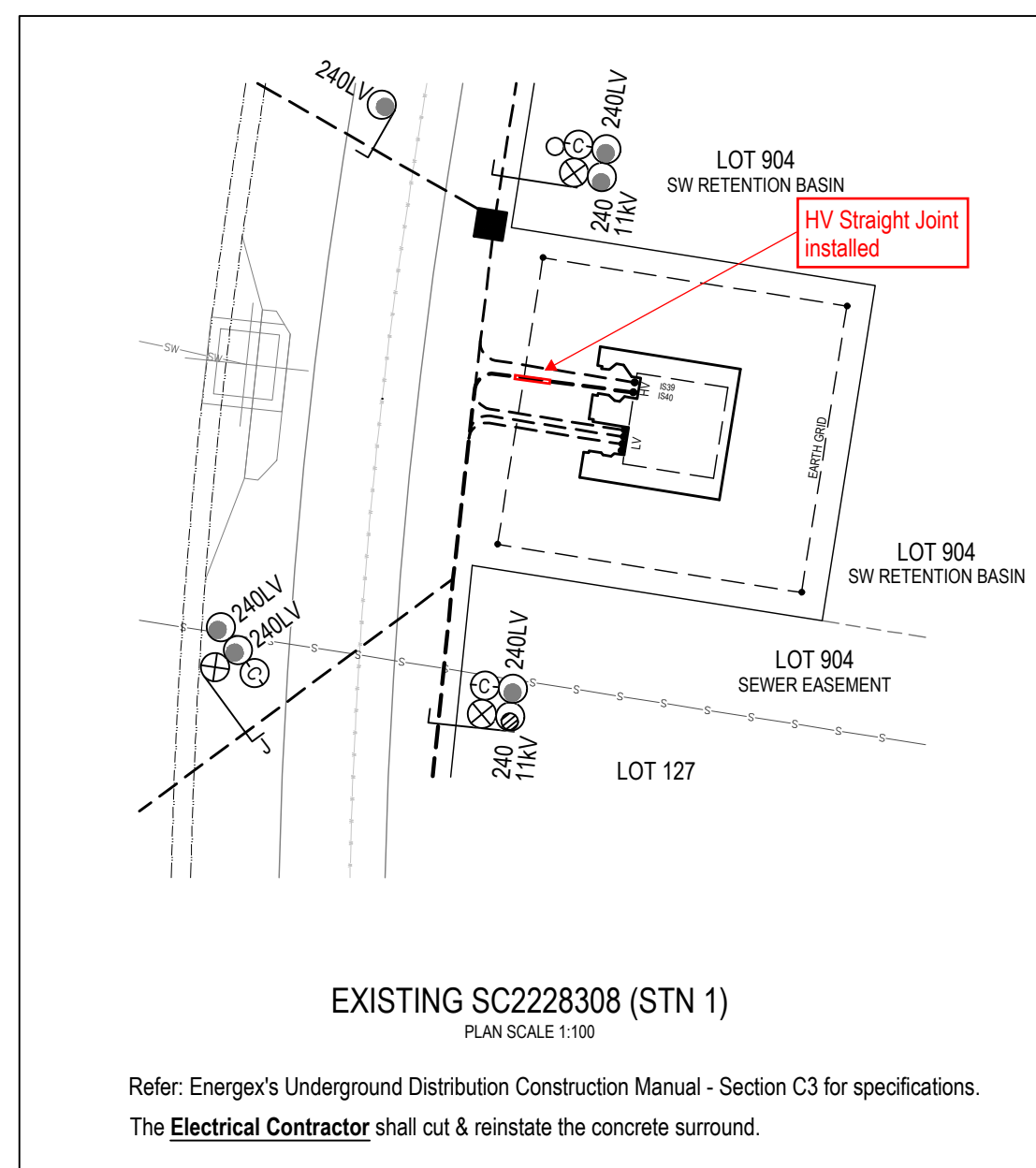

EXISTING SC2228308 (STN 1)
PLAN SCALE 1:100

Refer: Energex's Underground Distribution Construction Manual - Section C3 for specifications.
The Electrical Contractor shall cut & reinstaate the concrete surround.

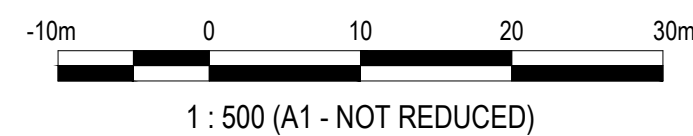

1 : 500 (A1 - NOT REDUCED)

MATERIALS SUMMARY - S0107462

UNDERGROUND			
MODEL No.	QTY	MODEL No.	QTY
11ST2424X	1	LVPT4C240	3
1350-1	2	LVSP12-6	1
1CF09524XLG	1	LVSP12-6SL	1
2DBST424D	1	LVSP14-6	2
6614	9	LVSP2-6	1
ADE	6	LVSP2-6SL	1
DSHV5SLK	1	LVSP4-6	6
DSLVF31	3	LVSP4-6SL	6
DSPMTEGSA	1	LVSP9-6	3
DSSQPMCEG	1	LVSP1240	3
LV4CMEN	4	S2477933	1
LV4CMENLINK	2	SC0019959	1
		SC0019960	1
		SCS820363	490
TOTAL		SCS820364	663
TRENCH LENGTH	460	SCS820365	37

PROPOSED COMMISSIONING PLAN

- Tentative only; subject to amendment by ENERGEX outage coordinator.
- SWITCHING ONE** - Commission 11kV underground; Commission SC2247548.
- 1 x HV & LV Switching
 - Make new 11kV terminations at SC2228308 - IS40.
 - Carry out commissioning checks and reverse switching.
 - Commission SC2247548
- SWITCHING TWO**
- 1 x LV Switching
 - Following a satisfactory site specific risk assessment by the Electrical Contractor terminate the new 240mm LV cable at the existing LIVE LV pillar at station 3 (U2228331).
 - Carry out commissioning checks and reverse switching.
 - Commission LV Circuit SC2228308 CCT 2
- SWITCHING THREE to FIVE**
- 1 x LV Switching
 - Following a satisfactory site specific risk assessment by the Electrical Contractor terminate the new 240mm LV cable on the spare LV switch-fuse in the LIVE LV Switchboard at station 36.
 - Carry out commissioning checks and reverse switching.
 - Commission each LV Circuit SC2247548
 - OPEN links at LP2230829
- Where interruptions to existing consumers are required, they shall be notified in line with ENERGEX policies.

AS CONSTRUCTED

UNDERGROUND POWER P/L

Name: Anders Larsen

Signature: [Signature]

Date: 15/11/2022

Phone: 07 3712 6930

LABELS

The contractor shall check label details against existing labels on site. Report any discrepancies immediately to the Contract Superintendent.

11kV RMU LABELS			AT FRONTIER DRIVE (STN 7) SC2247548				
LABEL SIZE	LABEL COLOUR	LETTER SIZE	LABEL INFORMATION			LABEL LOCATION	LABEL DESCRIPTION
100x40	WB	15	IS42	SF43	IS44	IS45	ISOLATOR IDENTIFICATION
150x40	BW	20					FEEDER IDENTIFICATION
150x50	BW	10	[SPARE]	TO TRANSFORMER	TO GUMTREE CRESCENT SC2228308 - IS40	[SPARE]	CABLE BOX CABLE DESTINATION
150x50	BW	10	[SPARE]	TO TRANSFORMER	TO GUMTREE CRESCENT SC2228308 - IS40	[SPARE]	INSIDE SIDE WALL CABLE DESTINATION

11kV RMU LABELS			AT GUMTREE CRESCENT (STN 1) SC2228308				
LABEL SIZE	LABEL COLOUR	LETTER SIZE	LABEL INFORMATION			LABEL LOCATION	LABEL DESCRIPTION
100x40	WB	15	IS39		IS40	SF41	ISOLATOR IDENTIFICATION
150x40	BW	20					FEEDER IDENTIFICATION
150x50	BW	10	[EXIST]	TO FRONTIER DRIVE SC2247548 - IS44	[EXIST]	[EXIST]	CABLE BOX CABLE DESTINATION
150x50	BW	10	[EXIST]	TO FRONTIER DRIVE SC2247548 - IS44	[EXIST]	[EXIST]	INSIDE SIDE WALL CABLE DESTINATION

DATE	REV	REVISION	APP.	DATE	REV	REVISION	APP.	CURRENT REVISION CHANGES:
29/11/2021	A	PRELIMINARY ISSUE	R.R.					
10/12/2021	B	REVISED LOT CALCULATIONS	R.R.					
30/03/2022	C	FOR CONSTRUCTION	R.R.					
10/08/2022	D	SL ALIGNMENTS AMENDED	R.R.					

COUNCIL: IPSWICH CITY
DESIGNED: W.Schardt
DRAWN: B.Hyland
CHECKED: B.Ryan
APPROVED: ROBIN RUSSELL RPEQ 1546
SIGNED: [Signature]

Robin Russell
& ASSOCIATES PTY. LTD.
CONSULTING ENGINEERS - ELECTRICAL

SUBDIVISION ELECTRICAL SERVICES
204/5 Barbara Street, Stafford, QLD 4053
Tel: (07) 3872 5555
Fax: (07) 3872 5566
Email: rr@robinrussell.com.au
www.robinrussell.com.au
A.B.N. 78 010 589 661

COUNCIL	IPSWICH CITY	DESIGNED	W.Schardt	DESCRIPTION	ELECTRICITY RETICULATION - RESIDENTIAL
COUNCIL REF	6536/2018/MAPDA	DRAWN	B.Hyland		
UBD REF	Map 233 Grd M17	CHECKED	B.Ryan		
DWT REV.	V53-3 20210504	APPROVED	ROBIN RUSSELL RPEQ 1546	CLIENT	Monterea Land Holdings Pty Ltd
DATE	29/11/2021	SIGNED	[Signature]		

LOCATION: **MONTEREA ESTATE STAGES 10 & 11**
236-240 MONTEREA ROAD
RIPLEY

THIS DOCUMENT IS COPYRIGHT AND THE PROPERTY OF ROBIN RUSSELL & ASSOCIATES PTY LTD AND MUST NOT BE RETAINED, COPIED OR USED WITHOUT AUTHORITY.

DRAWING No. **D844-02** **D**

ENERGEX PROJECT No. **S0107462** SHEET No. **2** OF **4**

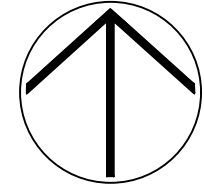

LV LINK PILLAR LABELS					AT MAGUIRE STREET LP2163921				
CIRCUIT DIRECTION	LABEL SIZE	LABEL COLOUR	LETTER SIZE	LABEL INFORMATION	CIRCUIT DIRECTION	LABEL SIZE	LABEL COLOUR	LETTER SIZE	LABEL INFORMATION
LHS	150x50	WB	5	TO GUMTREE CRESCENT SC2228308 / LIAM STREET LP2228327 / DEVLIN STREET LP2247568 / MAGUIRE STREET LP2228333 AND SERVICES	RHS	150x50	WB	5	[EXIST]

LHS & RHS AS VIEWED FROM ROAD TO PILLAR

LV LINK PILLAR LABELS					AT LIAM STREET LP2228327				
CIRCUIT DIRECTION	LABEL SIZE	LABEL COLOUR	LETTER SIZE	LABEL INFORMATION	CIRCUIT DIRECTION	LABEL SIZE	LABEL COLOUR	LETTER SIZE	LABEL INFORMATION
LHS	150x50	WB	5	TO GUMTREE CRESCENT SC2228308 / MAGUIRE STREET LP2163921 / DEVLIN STREET LP2247568 / MAGUIRE STREET LP2228333 AND SERVICES	RHS	150x50	WB	5	TO FRONTIER DRIVE SC2247548 / MAGUIRE STREET LP2228333 / FRONTIER DRIVE LP2247559 / DEVLIN STREET LP2247568 / JOHNSON CIRCUIT LP2230829 AND SERVICES

LHS & RHS AS VIEWED FROM ROAD TO PILLAR

LV LINK PILLAR LABELS					AT MAGUIRE STREET (STN 4) LP2228333				
CIRCUIT DIRECTION	LABEL SIZE	LABEL COLOUR	LETTER SIZE	LABEL INFORMATION	CIRCUIT DIRECTION	LABEL SIZE	LABEL COLOUR	LETTER SIZE	LABEL INFORMATION
LHS	150x50	WB	5	TO FRONTIER DRIVE SC2247548 / FRONTIER DRIVE LP2247559 / DEVLIN STREET LP2247568 / LIAM STREET LP2228327 / JOHNSON CIRCUIT LP2230829 AND SERVICES	RHS	150x50	WB	5	TO GUMTREE CRESCENT SC2228308 / DEVLIN STREET LP2247568 / LIAM STREET LP2163921 AND SERVICES

LHS & RHS AS VIEWED FROM ROAD TO PILLAR

LV LINK PILLAR LABELS					AT JOHNSON CIRCUIT LP2230829				
CIRCUIT DIRECTION	LABEL SIZE	LABEL COLOUR	LETTER SIZE	LABEL INFORMATION	CIRCUIT DIRECTION	LABEL SIZE	LABEL COLOUR	LETTER SIZE	LABEL INFORMATION
LHS	150x50	WB	5	[EXIST]	RHS	150x50	WB	5	TO FRONTIER DRIVE SC2247548 / MAGUIRE STREET LP2228333 / FRONTIER DRIVE LP2247559 / LIAM STREET LP2228327 / JOHNSON CIRCUIT LP2230829 AND SERVICES

LHS & RHS AS VIEWED FROM ROAD TO PILLAR

LV LINK PILLAR LABELS					AT DEVLIN ST (STN 34) LP2247568				
CIRCUIT DIRECTION	LABEL SIZE	LABEL COLOUR	LETTER SIZE	LABEL INFORMATION	CIRCUIT DIRECTION	LABEL SIZE	LABEL COLOUR	LETTER SIZE	LABEL INFORMATION
LHS	150x50	WB	5	TO FRONTIER DRIVE SC2247548 / MAGUIRE STREET LP2228333 / FRONTIER DRIVE LP2247559 / LIAM STREET LP2228327 / JOHNSON CIRCUIT LP2230829 AND SERVICES	RHS	150x50	WB	5	TO GUMTREE CRESCENT SC2228308 / MAGUIRE STREET LP2163921 / LIAM STREET LP2228327 / MAGUIRE STREET LP2228333 AND SERVICES

LHS & RHS AS VIEWED FROM ROAD TO PILLAR

LV LINK PILLAR LABELS					AT FRONTIER DRIVE (STN 21) LP2247559				
CIRCUIT DIRECTION	LABEL SIZE	LABEL COLOUR	LETTER SIZE	LABEL INFORMATION	CIRCUIT DIRECTION	LABEL SIZE	LABEL COLOUR	LETTER SIZE	LABEL INFORMATION
LHS	150x50	WB	5	[SPARE]	RHS	150x50	WB	5	TO FRONTIER DRIVE SC2247548 / MAGUIRE STREET LP2228333 / DEVLIN STREET LP2247568 / LIAM STREET LP2228327 / JOHNSON CIRCUIT LP2230829 AND SERVICES

LHS & RHS AS VIEWED FROM ROAD TO PILLAR

LV SWITCHBOARD LABELS					AT FRONTIER DRIVE (STN 7) SC2247548				
CIRCUIT No.	LABEL SIZE	LABEL COLOUR	LETTER SIZE	LABEL INFORMATION	CIRCUIT No.	LABEL SIZE	LABEL COLOUR	LETTER SIZE	LABEL INFORMATION
TRANSF. ISOLATOR	80x35	WB	6	TRANSFORMER ISOLATOR	1	80x35	WB	5	TO FRONTIER DRIVE U2247550 AND SERVICES
2	80x35	WB	5	TO MAGUIRE STREET LP2228333 / FRONTIER DRIVE LP2247559 / DEVLIN STREET LP2247568 / LIAM STREET LP2228327 / JOHNSON CIRCUIT LP2230829 AND SERVICES	3	80x35	WB	5	TO FRONTIER DRIVE U2247555 AND SERVICES
4	80x35	WB	5	[SPARE]					

LV SWITCHBOARD LABELS					AT GUMTREE CRESCENT (STN 1) SC2228308				
CIRCUIT No.	LABEL SIZE	LABEL COLOUR	LETTER SIZE	LABEL INFORMATION	CIRCUIT No.	LABEL SIZE	LABEL COLOUR	LETTER SIZE	LABEL INFORMATION
TRANSF. ISOLATOR	80x35	WB	6	TRANSFORMER ISOLATOR	1	80x35	WB	5	[EXIST]
2	80x35	WB	5	TO MAGUIRE STREET LP2163921 / LIAM STREET LP2228327 / MAGUIRE STREET LP2228333 / DEVLIN STREET LP2247568 AND SERVICES	3	80x35	WB	5	[EXIST]
4	80x35	WB	5	[SPARE]					

LV SWITCHBOARD LABELS					AT GUMTREE CRESCENT (STN 1) SC2228308				
CIRCUIT No.	LABEL SIZE	LABEL COLOUR	LETTER SIZE	LABEL INFORMATION	CIRCUIT No.	LABEL SIZE	LABEL COLOUR	LETTER SIZE	LABEL INFORMATION
TRANSF. ISOLATOR	80x35	WB	6	TRANSFORMER ISOLATOR	1	80x35	WB	5	[EXIST]
2	80x35	WB	5	TO MAGUIRE STREET LP2163921 / LIAM STREET LP2228327 / MAGUIRE STREET LP2228333 / DEVLIN STREET LP2247568 AND SERVICES	3	80x35	WB	5	[EXIST]
4	80x35	WB	5	[SPARE]					

LV SWITCHBOARD LABELS					AT GUMTREE CRESCENT (STN 1) SC2228308				
CIRCUIT No.	LABEL SIZE	LABEL COLOUR	LETTER SIZE	LABEL INFORMATION	CIRCUIT No.	LABEL SIZE	LABEL COLOUR	LETTER SIZE	LABEL INFORMATION
TRANSF. ISOLATOR	80x35	WB	6	TRANSFORMER ISOLATOR	1	80x35	WB	5	[EXIST]
2	80x35	WB	5	TO MAGUIRE STREET LP2163921 / LIAM STREET LP2228327 / MAGUIRE STREET LP2228333 / DEVLIN STREET LP2247568 AND SERVICES	3	80x35	WB	5	[EXIST]
4	80x35	WB	5	[SPARE]					

FOR CONSTRUCTION

AS CONSTRUCTED

UNDERGROUND POWER P/L

Name: Anders Larsen

Signature: _____

Date: 15/11/2022

Phone: 07 3712 6930

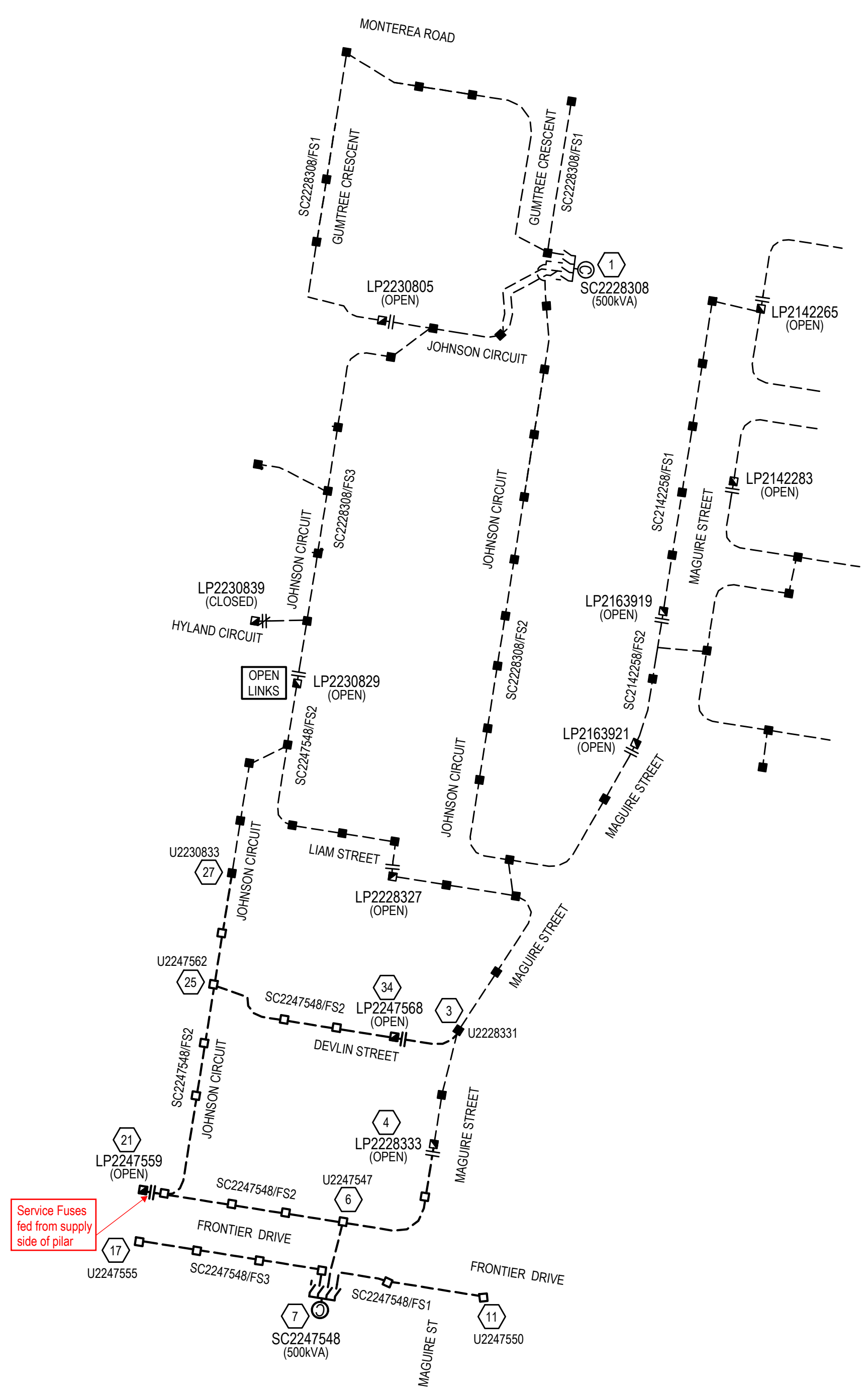

EXISTING AND PROPOSED LV SCHEMATIC
SCALE 1:1500
ALL NEW LV CABLES TO BE 4c 240mm AI XLPE UNO

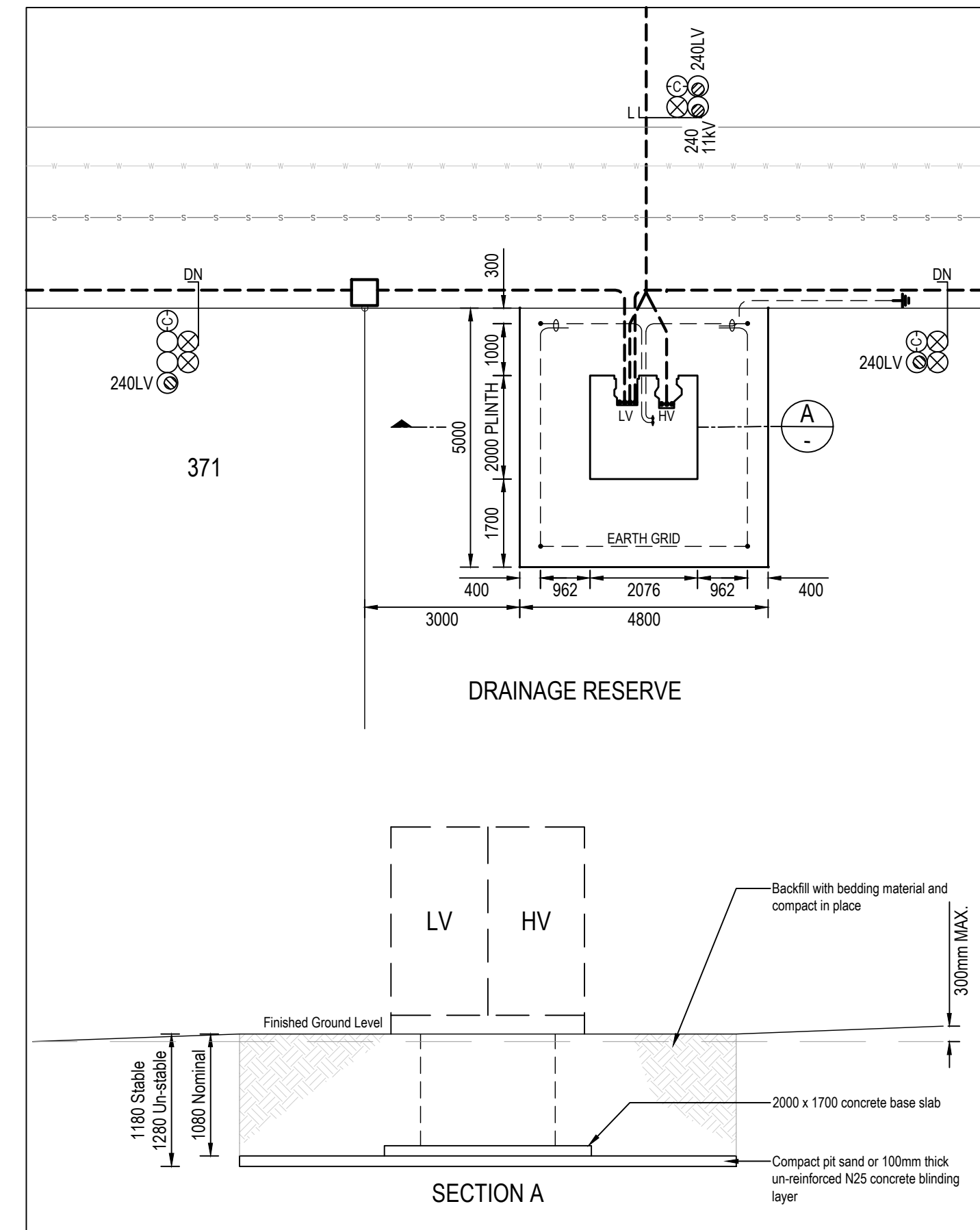

PROPOSED SC2247548 (STN 7)
PLAN SCALE 1:100 / SECTION A SCALE 1:50

Refer: EnergeX's Underground Distribution Construction Manual - Section C3 for specifications.

The **Civil Contractor** shall prepare a level site. If the ground level changes by more than 300mm across the PMT site & within 2m of the transformer site, then a retaining wall will be required, as specified in EnergeX's Manual. If the wall height exceeds 300mm, a safety fence will be required. Per Section A, retaining walls built within 2m of the PMT site require a foundation capable of supporting full excavation of the PMT site up to a depth of 1280mm.

The **Electrical Contractor** shall construct the transformer foundations. The **Electrical Contractor** shall arrange for a test of the bearing capacity of the excavated ground at the transformer site. If it appears to be less than 50 kPa (i.e. easily penetrated by thumb), cease construction and notify the Contract Superintendent immediately. A new foundation design may be required.

Note: Where retaining walls are not fully compliant with the requirements of the EnergeX Underground Distribution Construction Manual the wall and foundations **MUST** be located outside of the PMT site - an RPEQ approved structural design shall be provided to RRA to lodged with ENERGEX for approval **BEFORE** the walls are constructed.

DATE	REV	REVISION	APP.	DATE	REV	REVISION	APP.	CURRENT REVISION CHANGES:
29/11/2021	A	PRELIMINARY ISSUE	R.R.					
10/12/2021	B	REVISED LOT CALCULATIONS	R.R.					
30/03/2022	C	FOR CONSTRUCTION	R.R.					
10/08/2022	D	SL ALIGNMENTS AMENDED	R.R.					

Robin Russell
& ASSOCIATES PTY. LTD.
CONSULTING ENGINEERS - ELECTRICAL

SUBDIVISION ELECTRICAL SERVICES
2045 Babina Street, Stafford, QLD 4053
Tel: (07) 3872 5555
Fax: (07) 3872 5566
Email: r.russell@robinrussell.com.au
www.robinrussell.com.au
A.B.N. 78 010 589 661

COUNCIL	IPSWICH CITY	DESIGNED	W.Schardt	DESCRIPTION	ELECTRICITY RETICULATION - RESIDENTIAL
COUNCIL REF	6536/2018/MAPDA	DRAWN	B.Hyland	CLIENT	Montereia Land Holdings Pty Ltd
UBD REF	Map Grd 233	CHECKED	B.Ryan		
DWT REV.	V53-3 20210504	APPROVED	ROBIN RUSSELL RPEQ 1546		
DATE	29/11/2021	SIGNED	<i>R. Russell</i>		

LOCATION
MONTEREA ESTATE STAGES 10 & 11
236-240 MONTERA ROAD
RIPLEY

ENERGEX PROJECT No. **S0107462**

THIS DOCUMENT IS COPYRIGHT AND THE PROPERTY OF ROBIN RUSSELL & ASSOCIATES PTY LTD AND MUST NOT BE RETAINED, COPIED OR USED WITHOUT AUTHORITY.

DRAWING No. **D844-03** **D**

SHEET No. **3** OF **4**

A1

URD CONDUIT SCHEDULE - FOOTPATHS - BY ELECTRICAL CONTRACTOR

LOCATION	STATIONS FROM - TO	CONDUIT LENGTH (m)						X-SECTION (m)			DRAW WIRE	KERB MARKERS	REMARKS		
		50mm HD	No.	100mm LD	No.	125mm LD	No.	EQL 100mm COMMS MD	PVC CABLE PROTECTION (m)	EXCAV /TAPE				TRENCH DETAIL	
MAGUIRE ST	2 2 3 34 4 5 5 6														JOINT PIT EXISTING CONDUIT
FRONTIER DR	6 18 7 9 7 14			20	1	20	2	20	42	L	88				JOINT USE TRENCH. REFER NOTE 5
MAGUIRE ST	9 10			36	1	36	2	36	36	L	152				JOINT USE TRENCH. REFER NOTE 5
FRONTIER DR	11 12 14 15 15 16 16 17 18 19 20 21			35	1	35	2	35	35	L	148				JOINT USE TRENCH. REFER NOTE 5
JOHNSON CCT	22 23 23 24 24 25 25 26 26 27 29 30			11	1	1			22	D	24				
DEVLIN ST	30 32 32 34			22	1				24	D	24				
TOTAL				626m		488m		244m	460m		1468m				

- NOTES:
 1. CONDUITS SHALL BE INSTALLED WITHIN A CORRIDOR 250-750mm FROM PROPERTY ALIGNMENT, IN ACCORDANCE WITH ENERGENX UNDERGROUND DISTRIBUTION CONSTRUCTION (UDC) MANUAL.
 2. FOOTPATH CONDUITS SHALL HAVE MINIMUM 700mm COVER, REGARDLESS OF ENERGENX'S REQUIREMENTS.
 3. CONNECT EXISTING CONDUITS, INCLUDING ROAD CROSSING CONDUITS, TO NEW FOOTPATH CONDUITS
 4. TELECOMMUNICATION CONDUITS SHALL BE INSTALLED ABOVE THE ENERGENX CONDUITS IN A JOINT USE TRENCH ARRANGEMENT.
 5. REFER RRA CONSTRUCTION PLAN S0107463 (RRA D844) FOR JOINT USE TRENCH RATES CONDUIT INSTALLATION DETAILS.

URD CONDUIT SCHEDULE - ROADWAYS - BY CIVIL CONTRACTOR

LOCATION	STATIONS FROM - TO	CONDUIT LENGTH (m)						X-SECTION (m)			DRAW WIRE	KERB MARKERS	REMARKS	
		50mm HD	No.	100mm LD	No.	125mm LD	No.	EQL 100mm COMMS MD	PVC CABLE PROTECTION (m)	EXCAV /TAPE				TRENCH DETAIL
FRONTIER DR	6 7			23	2	23	2	23	23	N	125	2		INSTALL UNDER STORMWATER
MAGUIRE ST	9 11			39	1	39	2	39	39	L	164	2		
FRONTIER DR	19 20			28	1				28	D	30	2		
JOHNSON CCT	25 28			15	1				15	D	17	2		
DEVLIN ST	30 31 32 33			14	1				14	D	16	2		
TOTAL				157m		124m		62m	134m		369m	12		

- NOTES:
 1. ROAD CROSSING CONDUITS SHALL BE INSTALLED STRICTLY IN ACCORDANCE WITH THE ENERGENX UNDERGROUND DISTRIBUTION CONSTRUCTION (UDC) MANUAL.
 2. ROAD CROSSING CONDUITS SHALL HAVE A MINIMUM COVER OF 800mm AT ALL PLACES UNDER THE ROAD, EXCEPT UNDER STATE-CONTROLLED "MAIN" ROADS, WHERE CONDUITS SHALL HAVE A MINIMUM COVER OF 1200mm.
 3. CONDUITS SHALL EXTEND TO WITHIN 750mm OF PROPERTY ALIGNMENT; PVC PROTECTIVE COVER STRIPS SHALL BE LAID ABOVE ALL ROAD-CROSSING CONDUITS FOR THEIR FULL LENGTH.
 4. REFER ENERGENX UDC MANUAL SECT. C2 FOR CROSS-SECTION DETAILS
 5. BRASS "E" MARKERS SHALL BE INSTALLED IN KERBS DIRECTLY ABOVE ELECTRICITY CONDUITS.

CIVIL WORKS SCHEDULE - BY ELECTRICAL CONTRACTOR

LOCATION	STATIONS FROM - TO	CONDUIT LENGTH (m)						X-SECTION (m)			DRAW WIRE	KERB MARKERS	REMARKS	
		50mm HD	No.	100mm LD	No.	125mm LD	No.	EQL 100mm COMMS MD	PVC CABLE PROTECTION (m)	EXCAV /TAPE				TRENCH DETAIL
FRONTIER DR	20 22			34	1				34	D	36			
JOHNSON CCT	28 29			8	1				8	D	10			
TOTAL				42m					42m		46m			

- NOTES:
 1. CONDUITS SHALL BE INSTALLED WITHIN A CORRIDOR 250-750mm FROM PROPERTY ALIGNMENT, IN ACCORDANCE WITH ENERGENX UNDERGROUND DISTRIBUTION CONSTRUCTION (UDC) MANUAL.
 2. FOOTPATH CONDUITS SHALL HAVE MINIMUM 700mm COVER, REGARDLESS OF ENERGENX'S REQUIREMENTS.
 3. CONNECT EXISTING CONDUITS, INCLUDING ROAD CROSSING CONDUITS, TO NEW FOOTPATH CONDUITS
 4. TELECOMMUNICATION CONDUITS SHALL BE INSTALLED ABOVE THE ENERGENX CONDUITS IN A JOINT USE TRENCH ARRANGEMENT.
 5. WHEN CONSTRUCTING A RETAINING WALL ALONG THE FRONT OF A LOT, THE CIVIL CONTRACTOR MUST INSTALL CONDUITS FOR ELECTRICAL AND TELECOMMUNICATIONS LEAD-INS. REFER TO CONDUIT UNDER RETAINING WALL DETAIL.

CONDUIT BENDING RADIUS (mm)			
LOCATION	50mm Ø	100mm Ø	125mm Ø
HORIZONTAL BEND	600	1830	1830
PILLAR - MAIN CABLE	-	1200	-
PILLAR - X-ROAD CABLE	-	450	-
PILLAR - STREET LIGHT CABLE	600	-	-
STREET LIGHT	300	-	-
POLE TERMINATION	300	1200	1830
TRANSFORMER	no bends required		

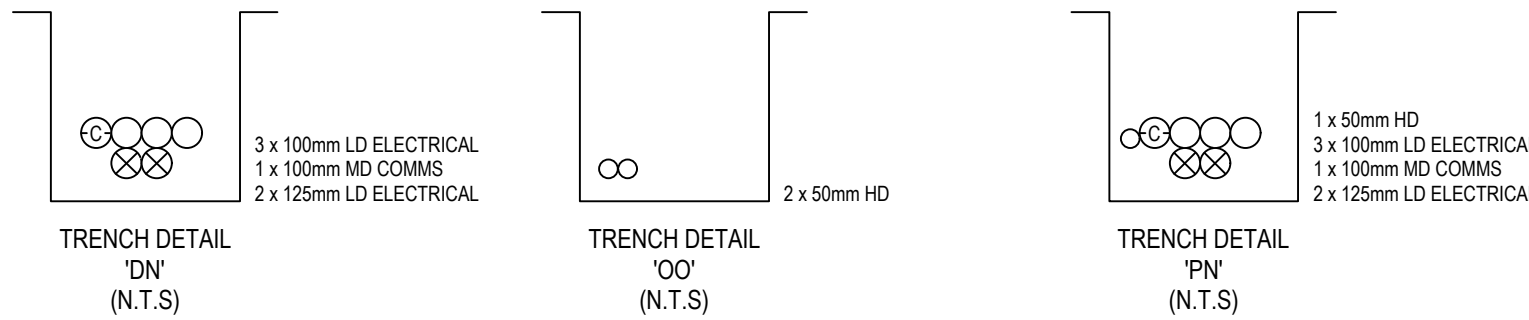

PROJECT SPECIFIC NON-STANDARD ENERGENX TRENCH DETAILS

UNDERGROUND CABLE SCHEDULE

LOCATION	STATIONS FROM - TO	VOLTS	EX	REC	IN	CABLE SIZE/TYPE	CU CODE	CABLE LENGTH (m)		REMARKS
								NEW	REC	
GUMTREE CRES	1 2	11kV			*	240mm² Al 3X1C TR XLPE/SCREEN/HDPE	SCS820363	290		
MAGUIRE ST	2 7 3 34 4 5 5 6 6 7 6 18 7 9 7 14	11kV LV LV LV LV LV LV LV			*	240mm² Al 3X1C TR XLPE/SCREEN/HDPE 240mm² Al 4C XLPE/PVC 240mm² Al 4C XLPE/PVC 240mm² Al 4C XLPE/PVC 240mm² Al 4C XLPE/PVC 240mm² Al 4C XLPE/PVC 240mm² Al 4C XLPE/PVC 240mm² Al 4C XLPE/PVC	SCS820363 SCS820364 SCS820364 SCS820364 SCS820364 SCS820364 SCS820364 SCS820364	200 30 24 46 34 27 36 20		
FRONTIER DR	9 11 14 15 15 16 16 17 18 19 19 20 20 21 20 23	LV LV LV LV LV LV LV LV			*	240mm² Al 4C XLPE/PVC 240mm² Al 4C XLPE/PVC 240mm² Al 4C XLPE/PVC 240mm² Al 4C XLPE/PVC 240mm² Al 4C XLPE/PVC 240mm² Al 4C XLPE/PVC 240mm² Al 4C XLPE/PVC 240mm² Al 4C XLPE/PVC	SCS820364 SCS820364 SCS820364 SCS820364 SCS820364 SCS820364 SCS820364 SCS820364	43 30 30 28 26 32 13 49		
JOHNSON CCT	23 24 24 25 25 26 25 30 26 27	LV LV LV LV LV			*	240mm² Al 4C XLPE/PVC 240mm² Al 4C XLPE/PVC 240mm² Al 4C XLPE/PVC 240mm² Al 4C XLPE/PVC 240mm² Al 4C XLPE/PVC	SCS820364 SCS820364 SCS820364 SCS820364 SCS820364	26 28 25 38 24		
DEVLIN ST	30 31 30 32 32 33 32 34	LV LV LV LV			*	16mm² Cu 4C XLPE/PVC 240mm² Al 4C XLPE/PVC 16mm² Cu 4C XLPE/PVC 240mm² Al 4C XLPE/PVC	SCS820365 SCS820364 SCS820365 SCS820364	18 26 19 28		
TOTALS	(Variance 0%)					240mm² Al 3X1C TR XLPE/SCREEN/HDPE 240mm² Al 4C XLPE/PVC 16mm² Cu 4C XLPE/PVC	SCS820363 SCS820364 SCS820365	490 663 37		

- NOTES:
 1. THE CONTRACTOR SHALL MEASURE ACTUAL CABLE LENGTHS REQUIRED, AFTER INSTALLATION OF CONDUITS, THEN ORDER CABLE ACCORDINGLY.

EQUIPMENT SCHEDULE

LOCATION	STN No.	SITE I.D.	EX	REC	IN	SIZE AND DESCRIPTION	COMP ID	CU CODE	QTY	REMARKS
GUMTREE CRES	1	SC2228308	*			EXISTING TRANSFORMER TO REMAIN 240mm² 11kV CFC TERM IN PADMOUNT CONCRETE SURROUND		2DBSTA24D	1	KIT CONTAINS 3x ELBOWS CONTRACTOR TO CUT, REMOVE AND REINSTATE
MAGUIRE ST	2	U2247545		*	*	11kV STRAIGHT JOINT HEATSHRINK CAP 25-55mm	CJ1	11ST24/24X 6614	1	240/240 AL TRIPLEX
	3	U2228331	*			3 WAY PILLAR 240mm 4 CORE CABLE LV LUG SET		LVSP1240	1	EXISTING TO REMAIN 1x240LV
	4	LP2228333	*			1 WAY LINK PILLAR 240mm 4 CORE CABLE LV LUG SET		LVSP1240	1	CONVERT TO 2 WAY 1x240LV
	5	U2247546				2 WAY PILLAR + SL	PI1	LVSP4-6SL	1	2x240LV, 2x4SL REFER TO NOTE 1
FRONTIER DR	6	U2247547		*	*	3 WAY PILLAR	PI1	LVSP9-6	1	3x240LV
	7	SC2247548		*	*	PADMOUNT TRANSFORMER - 500kVA CFC BASE SLAB UNICULVERT CONCRETE SURROUND COMMON EARTH GRID FOR SQUARE PMT ADDITIONAL EARTH HV FUSE SET FOR 500kVA SWITCHGEAR 240mm² 11kV CFC TERM IN PADMOUNT HEATSHRINK CAP 25-55mm 315A LV FUSE LINK FOR LV BOARD LV TERMINATION	TR1	S2477933 SC0019960 SC0019959	1 1 1 1 1 1 1 1 3	CONTRACTOR SUPPLIED CONTRACTOR SUPPLIED CONTRACTOR SUPPLIED DSSQPMCEG DSPMTEGSA DSHVFS5LK 1CFC9524XLG 6614 DSLVF31 LVPT4C240
MAGUIRE ST	9	U2247549		*	*	2 WAY PILLAR + SL	PI1	LVSP4-6SL	1	2x240LV, 2x4SL REFER TO NOTE 1
FRONTIER DR	11	U2247550		*	*	1 WAY PILLAR + SL PILLAR MEN EARTHING	PI1	LVSP2-6SL LV4CMEN	1	1x240LV, 1x4SL
	14	U2247552		*	*	2 WAY PILLAR	PI1	LVSP4-6	1	2x240LV
	15	U2247553		*	*	2 WAY PILLAR + SL	PI1	LVSP4-6SL	1	2x240LV, 1x4SL
	16	U2247554		*	*	2 WAY PILLAR + SL	PI1	LVSP4-6SL	1	2x240LV, 1x4SL
	17	U2247555		*	*	1 WAY PILLAR PILLAR MEN EARTHING	PI1	LVSP2-6 LV4CMEN	1	1x240LV
	18	U2247556		*	*	2 WAY PILLAR PILLAR MEN EARTHING	PI1	LVSP4-6 LV4CMEN	1	2x240LV
	19	U2247557		*	*	2 WAY PILLAR + SL	PI1	LVSP4-6SL	1	2x240LV, 1x4SL
	20	U2247558		*	*	3 WAY PILLAR	PI1	LVSP9-6	1	3x240LV
	21	LP2247559		*	*	1 WAY LINK PILLAR LINK PILLAR MEN EARTHING GALVANISED PIPE BOLLARD	PI3	LVSP14-6 LV4CMENLINK 1350-1	1 2	1x240LV
JOHNSON CCT	23	U2247560		*	*	2 WAY PILLAR	PI1	LVSP4-6	1	2x240LV
	24	U2247561		*	*	2 WAY PILLAR PILLAR MEN EARTHING	PI1	LVSP4-6 LV4CMEN	1	2x240LV
	25	U2247562		*	*	3 WAY PILLAR	PI1	LVSP9-6	1	3x240LV
	26	U2247563		*	*	2 WAY PILLAR + SL	PI1	LVSP4-6SL	1	2x240LV, 1x4SL
	27	U2230833	*			1 WAY PILLAR 240mm 4 CORE CABLE LV LUG SET		LVSP1240	1	CONVERT TO 2 WAY 1x240LV
DEVLIN ST	30	U2247564		*	*	2 WAY PILLAR	PI1	LVSP4-6	1	2x240LV, 1x16LV
	31	U2247565		*	*	CROSS-ROAD PILLAR + SL	PI1	LVSP12-6SL	1	1x16LV, 2x4SL REFER TO NOTE 1
	32	U2247566		*	*	2 WAY PILLAR	PI1	LVSP4-6	1	2x240LV, 1x16LV
	33	U2247567		*	*	CROSS-ROAD PILLAR	PI1	LVSP12-6	1	1x16LV
	34	LP2247568		*	*	2 WAY LINK PILLAR LINK PILLAR MEN EARTHING	PI3	LVSP14-6 LV4CMENLINK	1	2x240LV

- NOTES:
 1. CONVERT TO 8 FUSE PANEL. MOVE NEUTRAL BAR TO BACK OF PANEL.

FOR CONSTRUCTION

AS CONSTRUCTED
 UNDERGROUND POWER P/L
 Name: Anders Larsen
 Signature:
 Date: 15/11/2022
 Phone: 07 3712 6930

DATE	REV	REVISION	APP.	DATE	REV	REVISION	APP.	CURRENT REVISION CHANGES:	 Robin Russell & ASSOCIATES PTY. LTD. CONSULTING ENGINEERS - ELECTRICAL SUBDIVISION ELECTRICAL SERVICES 204/6 Sabana Street, Stafford, QLD 4053 Tel: (07) 3872 5556 Fax: (07) 3872 5566 Email: m@robruss.com.au www.robruss.com.au A.B.N. 78 010 589 661	COUNCIL	IPSWICH CITY	DESIGNED	W.Schardt	DESCRIPTION	ELECTRICITY RETICULATION - RESIDENTIAL	LOCATION	MONTEREA ESTATE STAGES 10 & 11 236-240 MONTERA ROAD RIPLEY	DRAWING No.	D844-04	D
29/11/2021	A	PRELIMINARY ISSUE	R.R.							COUNCIL REF	6536/2018/MAPDA	DRAWN	B.Hylland							
10/12/2021	B	REVISED LOT CALCULATIONS	R.R.							UBD REF	Map Grd 233 M17	CHECKED	B.Ryan	CLIENT	MONTEREA LAND HOLDINGS PTY LTD	ENERGENX PROJECT No.	S0107462	SHEET No.	4 OF 4	
30/03/2022	C	FOR CONSTRUCTION	R.R.							DWT REV.	V53-3 20210504	APPROVED	ROBIN RUSSELL RPEQ 1546							
10/08/2022	D	SL ALIGNMENTS AMENDED	R.R.							DATE	29/11/2021	SIGNED								

THIS DOCUMENT IS COPYRIGHT AND THE PROPERTY OF ROBIN RUSSELL & ASSOCIATES PTY LTD AND MUST NOT BE RETAINED, COPIED OR USED WITHOUT AUTHORITY.

A1