

REGISTERED SURVEYOR'S CERTIFICATION
 LandPartners Pty Ltd hereby certify that the vertical and horizontal locations and dimensions shown on this plan are a true and correct record and were located by survey.
 Ross McDowall (Director)
 LandPartners Pty Ltd, Reg. Surveyor No. S4118 Date: 17/08/2021

ENGINEER'S CERTIFICATION
 I, Nicholas Rozis, hereby certify that:
 1. The information contained in this drawing / document is in compliance with approved drawings and design.
 2. The new water and sewerage works defined by this drawing have been designed and constructed in accordance with the SEQ Code.
 3. This represents an accurate record of as-constructed works.
 4. I accept responsibility for the information contained in this drawing / document.
 RPEQ (signature) RPEQ No. 7729 Date: 23/08/2021

AS CONSTRUCTED

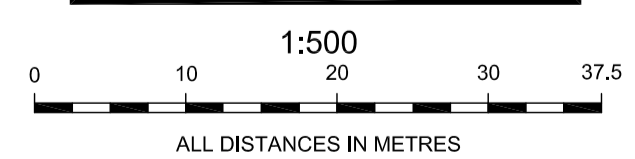

| | | | | | | |
|-----------|-------|------------|---------------|-------|---------|--------|
| A1 | 1 | 17/08/2021 | INITIAL ISSUE | VO | RA | RA |
| | INDEX | DATE | REVISIONS | DRAWN | CHECKED | PASSED |

| | | |
|----------|------|------------|
| DRAWN | VO | 17/08/2021 |
| CHECKED | RA | 17/08/2021 |
| PASSED | RA | 17/08/2021 |
| INITIALS | DATE | |



Queensland Urban Utilities
 236-240 MONTEREA RD PRECINCT 2 - STAGE 2
 AS CONSTRUCTED SEWER

| | |
|-------------|-------------------|
| SCALE | 1:500 |
| SHEET 1 | OF 1 SHEETS |
| DRAWING NO. | BRSS6904-002-48-1 |

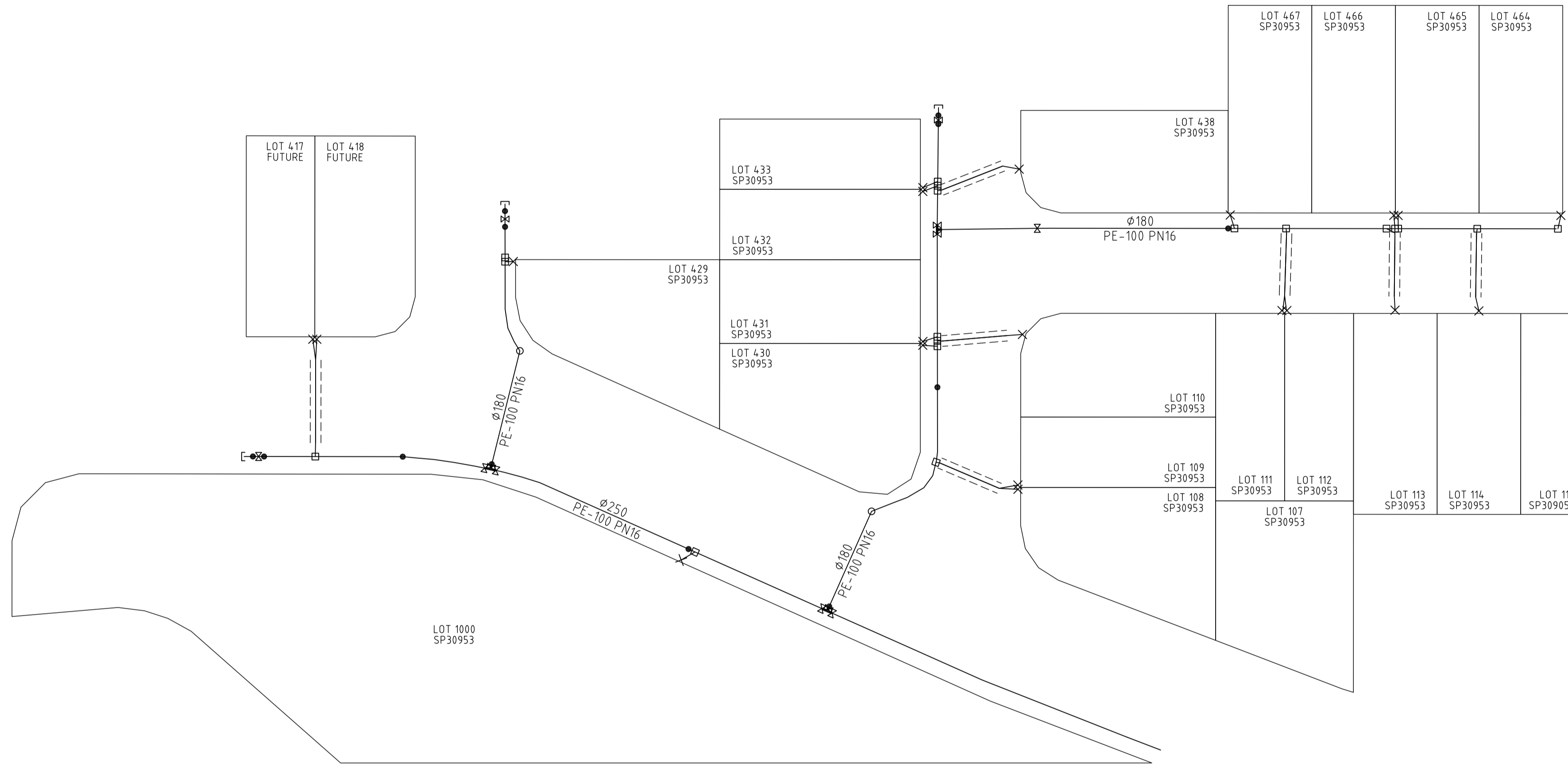
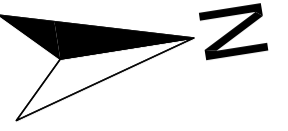

LEGEND

| | |
|---|--------------|
| ● | FIRE HYDRANT |
| ⊗ | STOP VALVE |
| ⊠ | TAPPING BAND |
| ⊕ | WATER METER |
| ⊖ | END CAP |
| ⊕ | TEE |
| ⊗ | REDUCER |
| ⊖ | BEND |
| — | WATER MAIN |

REGISTERED SURVEYOR'S CERTIFICATION

.....LandPartners Pty Ltd..... hereby certify that the vertical and horizontal locations and dimensions shown on this plan are a true and correct record and were located by survey.

.....*Rose McDowall*..... (Director)
 LandPartners Pty Ltd, Reg. Surveyor No. S4118 Date: 17/08/2021

ENGINEER'S CERTIFICATION

I, **Nicholas Rozis**..... hereby certify that:

- The information contained in this drawing / document is in compliance with approved drawings and design.
- The new water and sewerage works defined by this drawing have been designed and constructed in accordance with the SEQ Code.
- This represents an accurate record of as-constructed works.
- I accept responsibility for the information contained in this drawing / document.

----- RPEQ (signature) RPEQ No. 7729 Date: 23/08/2021

AS CONSTRUCTED

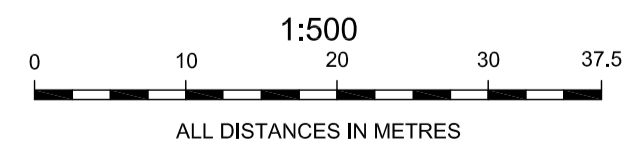

| | | | | | | |
|-----------|-------|------------|------------------|-------|---------|--------|
| A1 | 2 | 17/08/2021 | MINOR AMENDMENTS | VO | RA | RA |
| | 1 | 17/08/2021 | INITIAL ISSUE | VO | RA | RA |
| | INDEX | DATE | REVISIONS | DRAWN | CHECKED | PASSED |
| | | | | | | |

| | | |
|----------|----|------------|
| DRAWN | VO | 17/08/2021 |
| CHECKED | RA | 17/08/2021 |
| PASSED | RA | 17/08/2021 |
| INITIALS | | DATE |



Queensland Urban Utilities

236-240 MONTEREA RD PRECINCT 2 - STAGE 2
 AS CONSTRUCTED WATER

| | |
|-------------|-------------------|
| SCALE | 1:500 |
| SHEET 1 | OF 1 SHEETS |
| DRAWING NO. | BRSS6904-002-49-2 |